



## AUTOMATIC REVOLVING DOOR SYSTEMS

[www.exodoor.com](http://www.exodoor.com)



# INSTALLATION GUIDE

---

## A. REQUIRED TOOLS

The following equipment will be required during the installation process:

1. **Drill** (*Battery-powered recommended*)
  2. **Screwdriver / Socket Wrench** (*Battery-powered recommended*)
  3. **Marker or Pencil**
  4. **Silicone and Gun**
  5. **Leveler**
- 

## B. PREPARING THE INSTALLATION SITE

Proper preparation before installation is critical for a smooth process:

1. Check the **dimensions** and **ground level** of the installation area.
  2. **Level out** any roughness on the installation ground.
  3. Ensure that the installation site is **clean**.
- 

## C. INSTALLATION STEPS

Follow these steps to complete the installation:

### **C.1. Ground Drawing and Placement**

Mark the areas where the structure elements will be placed.

### **C.2. Mounting Canopy and Strut Profiles**

Install the supporting profiles in the designated positions.

### **C.3. Assembling Skirt Profiles**

Attach the bottom edge profiles to complete the framework.

### **C.4. Installing Curved Glass**

Carefully place and secure the curved glass panels.

### **C.5. Ceiling Sheets Installation**

Install the overhead (ceiling) panels.

### **C.6. Installing the Middle Strut**

Place and secure the middle support profile.

### **C.7. Assembling Door Leafs and Handles**

Install the door leaves and door handles.

### **C.8. Silicone Application & Door Operation Check**

Apply silicone at the joints for water sealing.

Ensure the door operates smoothly and check functionality.

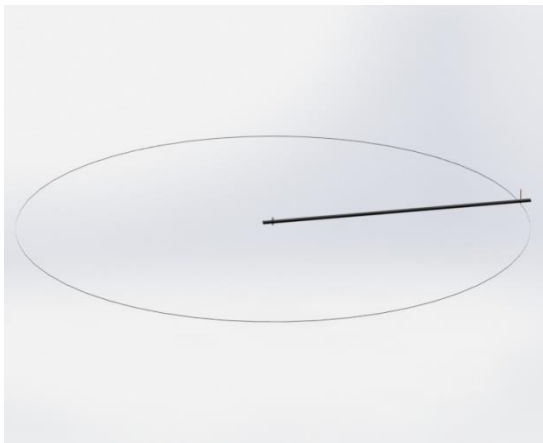

**Ground drawing**

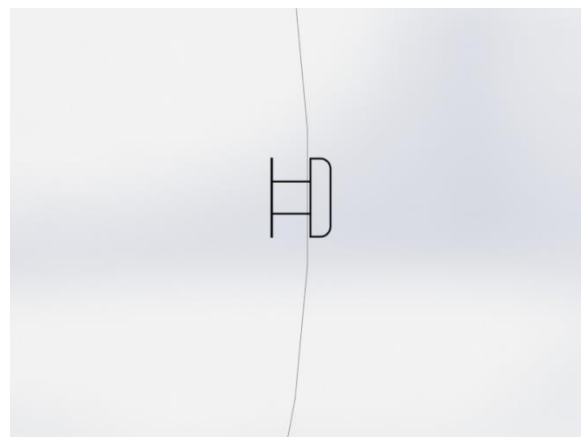

**Installation of strut profiles**



**Skirt profiles top view**



**Mounting of the Central  
Record Profile**



**Strut Mounting**

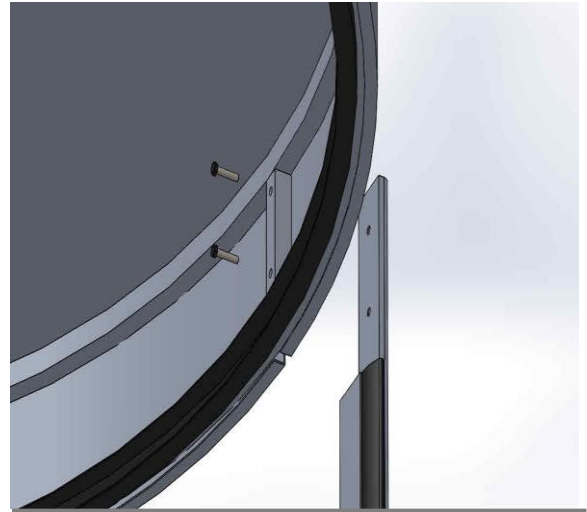

**Make The Connection To The  
Canopy,**



**Mounting to Floor and Boots**

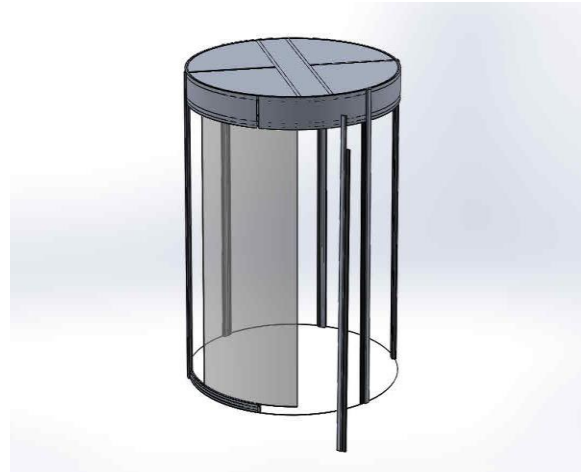

**Mounting of Dished Glass**



**Central Carrier Mounting**

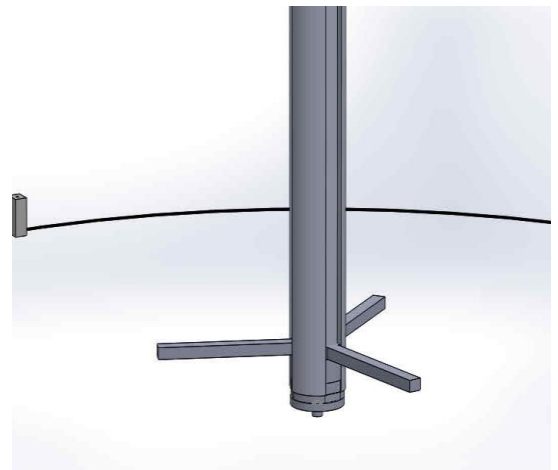

**Middle Shaft Mounting**

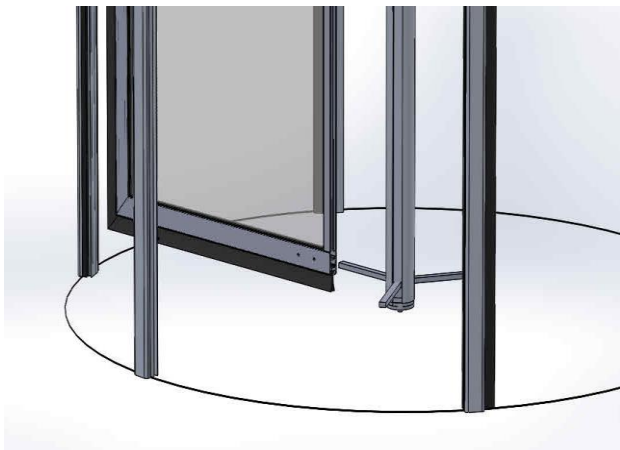

**Wing Mounting**

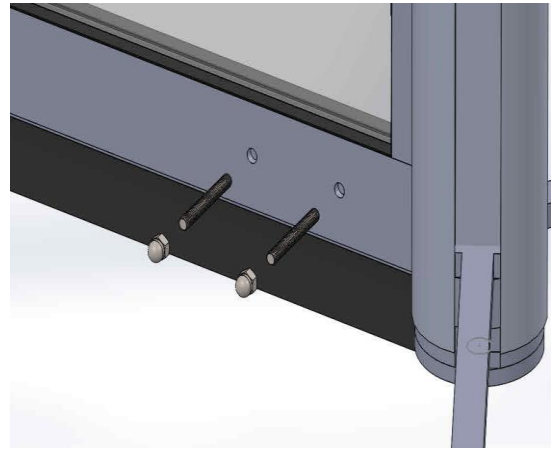

**Shaft Connection to Wings.**

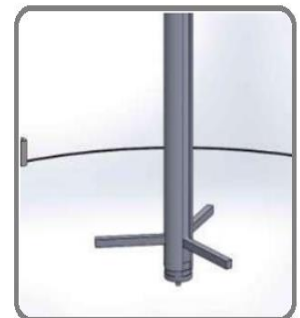
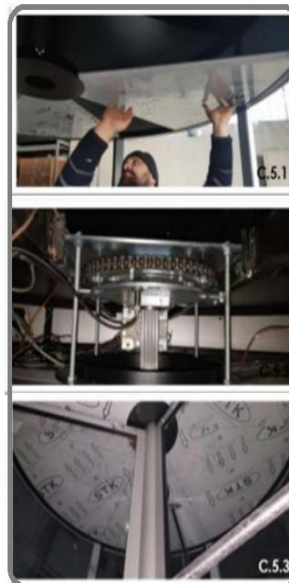
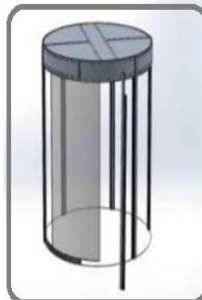
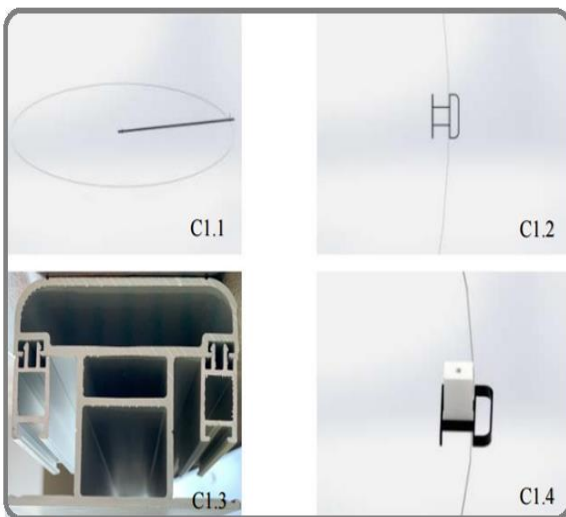



## LCD PANEL – OPERATION & SETTINGS

### User-Friendly Control and Instant Access to System Status

The LCD panel is a touch-sensitive digital interface that displays the status of the door and allows for user-friendly adjustment of general settings. It enables users to configure essential parameters with ease.

The system is powered by a **PLC controller with a unique MAC address**, which allows **remote access** through proper configuration and **port forwarding**.

Moreover, the **HMI screen** offers a clear advantage by displaying both temporary and permanent error codes. This eliminates the need for manual fault detection—allowing technicians to quickly resolve issues based solely on the error codes shown on the screen, saving both time and effort.

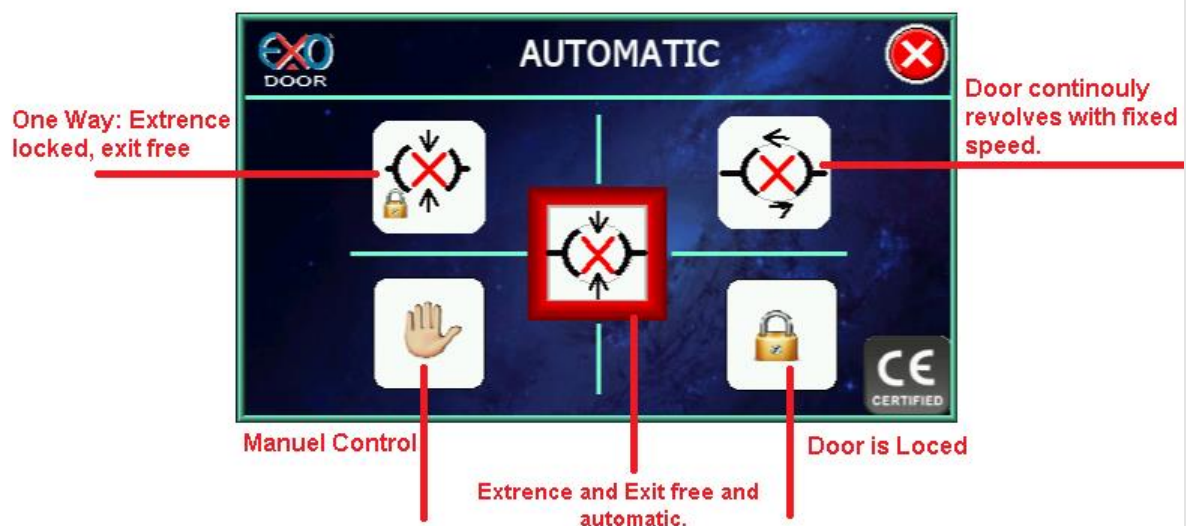



Enter the password to enter the settings,



Green: Active

Red: Inactive

Selection of number of leaves











These settings are accessible only for company authorized people



## ★ SAMPLE SYSTEM CONFIGURATIONS

### Speed & Safety Parameters for Optimized Performance

Below are key examples of system settings that can be configured via the LCD panel or through remote PLC access. These parameters are designed to optimize door performance, enhance user safety, and adapt to various operational needs:

-  **SLOW SPEED**  
Initial low-speed rotation before the door starts moving.  
*(Ensures smooth and safe start-up.)*
-  **HANDICAPPED SPEED**  
Special low-speed setting designed for individuals with disabilities.  
*(Allows for safe and comfortable access.)*
-  **NORMAL SPEED**  
Standard operational speed during normal door movement.
-  **JOG ACCELERATION SPEED**  
Acceleration rate at the start of door movement.  
*(Prevents abrupt starts and protects mechanical components.)*
-  **JOG SLOW SPEED**  
Deceleration speed when the door is coming to a stop.  
*(Enables soft, quiet stopping for better user experience.)*
-  **CURRENT LIMIT**  
Current multiplier used for torque control.  
*⚠ Should only be adjusted by authorized personnel.*
-  **CURRENT READ**  
Real-time display of the current multiplier value.  
*(Used for diagnostics and system monitoring.)*
-  **LOCK TIME**  
Duration after which the system detects a jamming or obstruction.
-  **SAFE STOP TIME**  
Delay time from a stationary position to initial movement.  
*(Adds extra safety before door starts rotating.)*

💡 These settings can be customized based on the site's traffic intensity and operational scenarios. While enhancing the user experience, they also contribute to energy efficiency and advanced safety.





### ⚠ Error Notifications;

The system is equipped with a diagnostic feature that automatically detects and reports malfunctions or irregularities during operation.



## GENERAL SAFETY INSTRUCTIONS

- A) Always make sure to understand and comply with the national safety regulations of the country where the revolving door will be installed.
- B) Electrical connections must be made in accordance with applicable standards and regulations.
- C) Do not perform any intervention without disconnecting the power supply.
- D) Installation of the automatic door must be carried out by an authorized and trained operator with occupational safety certification.
- E) Ensure that all connections, operations, maintenance, and repairs are performed by qualified and trained personnel.
- F) Read this manual carefully before operating the revolving door. Failure to follow the instructions may result in serious injury, loss of life, or equipment damage.
- G) Do not attempt to operate, service, maintain, or replace any parts without thoroughly reading and understanding the user manual.
- H) Never perform service or maintenance while the device is in operation.
- I) In case of malfunction, maintenance must be performed only by authorized technical personnel.
- J) Only original spare parts should be used for any part replacements.
- K) The company is not responsible for any issues resulting from improper connections, misuse, unauthorized repairs, poor maintenance, or inadequate storage.
- L) Dust and dirt from the operating area of the automatic door may enter the system. Keep the surrounding environment clean.
- M) Do not touch the moving parts of the device with tools or other objects during operation.
- N) Do not remove protective covers from electrical devices.
- O) Do not use compressed air or liquid substances to clean the control unit or electrical devices.
- P) Disabling or removing safety equipment may cause serious injury or damage to the system.
- Q) Do not remove warning labels on the device. If any labels are damaged, contact the manufacturer immediately.
- R) Touching rotating or moving parts may result in severe injury.
- S) All electrical inspections, maintenance, and adjustments must be carried out by a certified electrician. Ensure the power is off when replacing electrical components. Place a warning sign on the control panel to prevent accidental power-on during maintenance.

### NOTE:

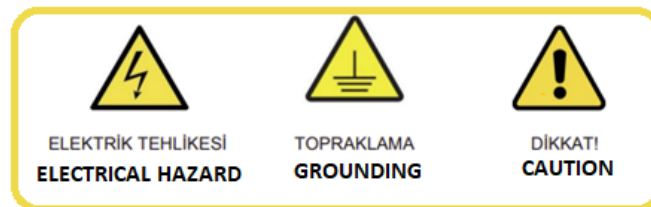

Children and pets **must not be allowed** to play inside or near the revolving door. Always ensure that they are **accompanied and supervised by an adult**.

**İMAJ YAPI OTOM SİST SAN VE TİC LTD. ŞTİ.** is not responsible for any damages or injuries resulting from failure to follow these safety instructions.

**Using a damaged or malfunctioning revolving door is strictly prohibited.**

In the event of a fault or damage, please contact:

**İMAJ YAPI OTOM SİST SAN VE TİC LTD. ŞTİ.** immediately.



## **DÖNER KAPI SİSTEMLERİ**

REVOLVING DOOR SYSTEMS

YÜKSEK VERİMLİLİK  
HIGH EFFICIENCY

MÜKEMMEL DETAYLAR  
PERFECT DETAILS

UZUN ÖMÜRLÜ KULLANIM  
DURABLE PRODUCTS

DİKKAT ÇEKİCİ TASARIMLAR  
REMARKABLE DESIGNS

Doğruların Kesişim Noktası



İMAJ YAPI OTO.SİST.SAN VE TİC.LTD.ŞTİ.

Seyrantepe Mh. İbrahim Karaoğlanoğlu Cd.No:55 34418

KAĞITHANE / İSTANBUL

Tel. : 0212 270 00 44-45

Faks : 0212 270 44 11

[www.exodoor.com](http://www.exodoor.com) / [info@exodoor.com.tr](mailto:info@exodoor.com.tr)